

DIRECTIONAL VALVE
Max. Capacity: 10,000

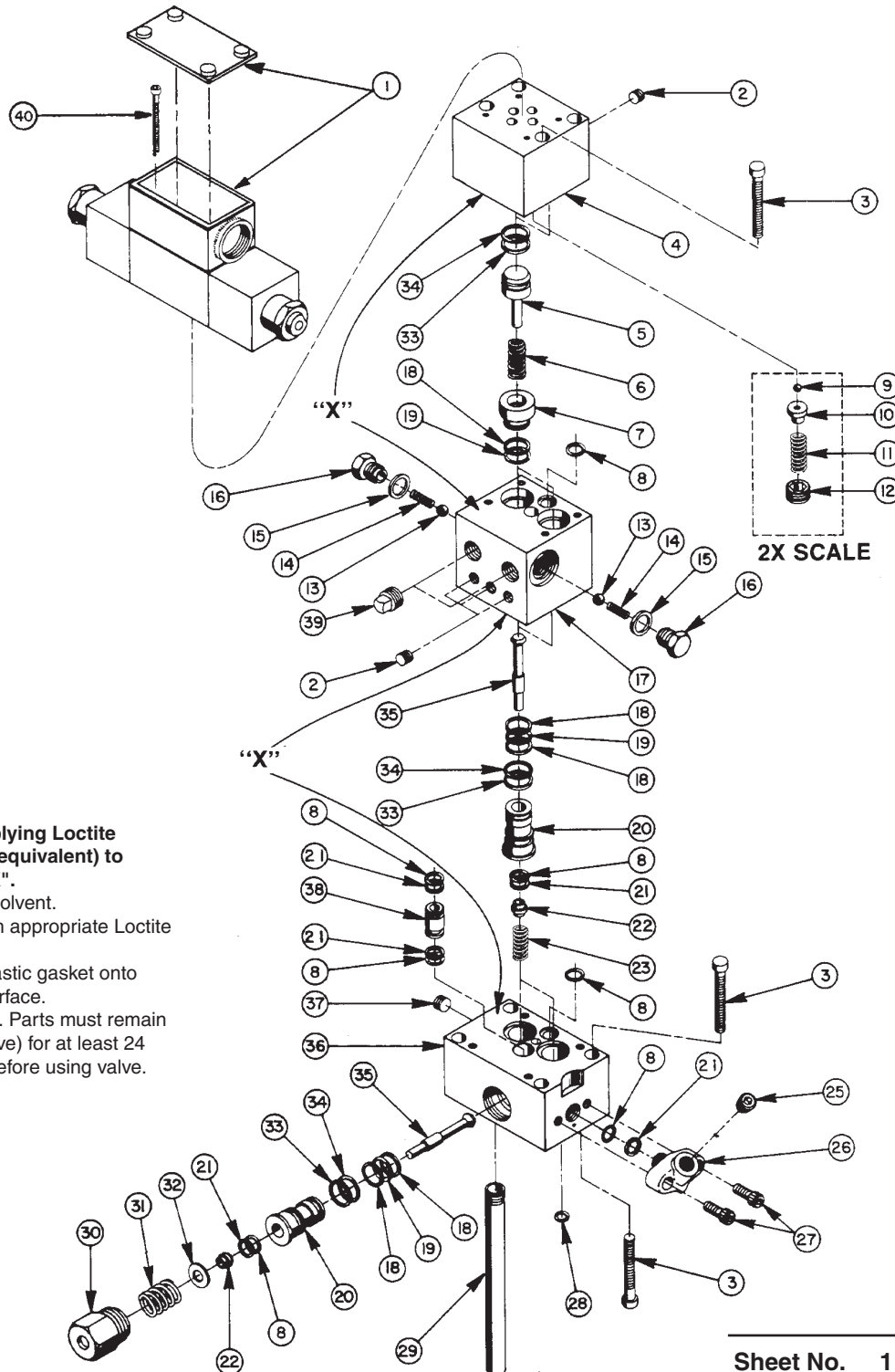

NOTE:

Procedure for applying Loctite gasket (No. 68 or equivalent) to surfaces noted "X".

1. Clean parts in solvent.
2. Prime parts with appropriate Loctite Primer.
3. Roll a film of plastic gasket onto each mating surface.
4. Assemble parts. Parts must remain at 70°F (or above) for at least 24 hours to cure before using valve.

Parts List, Form No. 100411, Back sheet 1 of 2

Item No.	Part No.	No. Req'd	Description
1	16664-4	1	Solenoid (24 volt, 50/60 Hz (For 9601 & V34S))
	16664-1	1	Solenoid (115 volt, /50/50 Hz (For 9607))
			Note: When replacing coils only, contact the factory.
2	10427	4	Pipe Plug (1/8 NPTF)
3	10890	12	Soc. Hd. Cap Screw (1/4 20 X 2" Lg.; Torque to 200/220 in. lbs. (Four are used for remote mounting; torque those to 70/80 in. lbs.)
4	50952	1	Top Cap
5	202476	2	Pilot Piston
6	10366	2	Compression Spring (1/2 O.D. x 1" Lg.)
7	202475	2	Valve Seat
8	10268*	10	O-ring (1/2 X 3/8 X 1/16)
9	10418	1	Steel Ball (1/8" Dia.)
10	202499	1	Spring guide
11	16665	1	Compression Spring (5/32 I.D. X 1/2" Lg.)
12	16704	1	Soc. Hd. Jam Screw (5/16-24 UNF X 5/32 Lg.)
13	14476	2	Steel Ball (11/32" Dia.)
14	12195	2	Compression Spring (1/4 O.D. X 1/2" Lg.)
15	14874*	2	Copper Washer (11/16 X 1/2 X 1/32)
16	29784	2	Valve Screw (Torque to 35/40 ft. lbs.)
17	50948	1	Center Body
18	12391*	8	Backup Washer (11/16 X 9/16 X 1/16)
19	11284*	5	O-ring (11/16 X 9/16 X 1/16)
20	22068	3	Bushing
21	11863*	3	Backup Washer (1/2 X 3/8 X 1/16)
22	202479	3	Spring Guide
23	11195	2	Compression Spring (1/2 O.D. X 3/4" Lg.)
25	10479	1	Pipe Plug (1/4 NPTF)
26	20866	1	Gauge Fitting
27	10006	2	Soc. Hd. Cap Screw (1/4-20 UNC X 5/8 Lg.; Torque to 70/80 in. lbs.)
28	10266*	1	O-ring (3/8 X 1/4 X 1/16)
29	200609	1	Drain Tube
30	202494	1	Spring Retainer
31	14979	1	Compression spring (3/4 O.D. X 1" Lg.)
32	16668	1	Washer (5/8 X 5/32 X 1/16)
33	12392*	5	Backup Washer (3/4 X 5/8 X 1/16)
34	10302*	5	O-ring (3/4 X 5/8 X 1/16)
35	200542	3	Balanced Poppet Half
36	50949	1	Valve Sub-plate
37	10909	1	Pipe Plug (3/8 NPTF)
38	21094	1	Bushing
39	11127	2	Pipe Plug (3/8 NPTF)
40	14423	4	Soc. Hd. Cap Screw (#10-24 X 2" Lg. - Torque to 35/40 in. lbs. (Sol. Valve Mtg.))
	50951	1	Basic Valve Ass'y (Less Solenoid and Sub-plate)

PARTS INCLUDED BUT NOT SHOWN

204810	1	Patent No. Decal
202524	1	Trade Name Decal (For V34S)
208358*	1	Warning Decal
208413	1	Corporate Decal (For 9601)
209187	1	Corporate Decal (For 9607)

Part numbers marked with an asterisk (*) are contained in Repair Kit No. 300494.

SPECIFICATIONS

OPERATION

Neutral (Hold): When both solenoids are deenergized, oil from pump circulates at free flow from the pressure port "P" to tank "T". Both cylinder ports are blocked.

Solenoid "A" Energized: Pressure to cylinder port "Z". Cylinder port "B" to tank.

Solenoid "B" Energized: Pressurized to cylinder port "B". Cylinder port "A" to tank.

NOTE: Pressure holds without loss when shifted from cylinder port to the neutral (Hold) position.

