

STRONG BOX PULLER SET

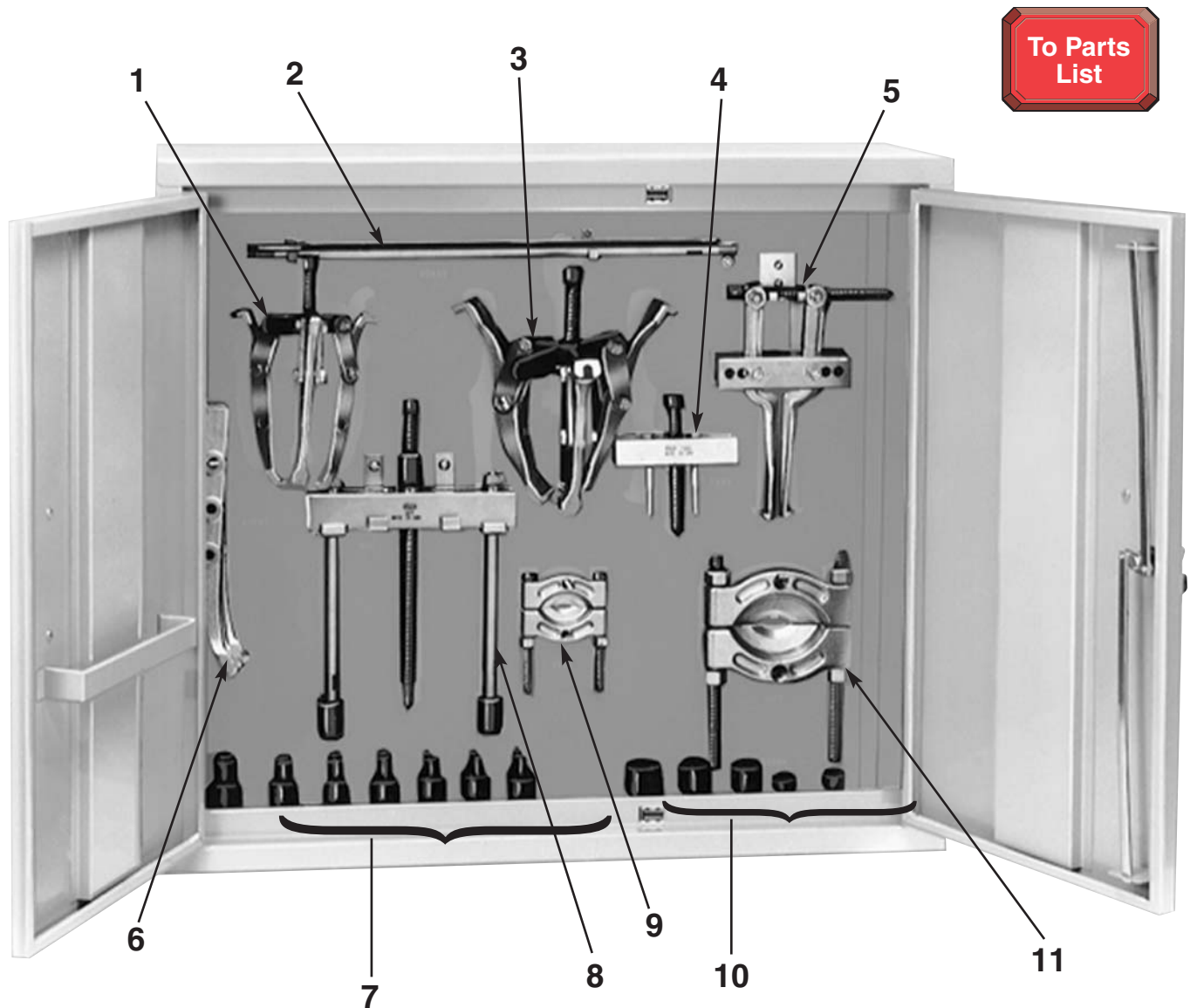

Item No.	Part No.	No. Req'd	Description
1	1027	1	Combination Puller (5 ton; 2/3 jaw)
2	1101	1 pr.	Puller Legs (15-3/4)
3	1037	1	Combination Puller (7 ton; 2/3 jaw)
4	7393	1	Gear and Pulley Puller
5	1152	1	Internal Pulling Attachment
6	43892	3	Long Jaw (For 1037)
7	8005	2	Male/Female Threaded Adapter (5/8 - 18 F. X 3/8 - 16 M.)
	8006	2	Male/Female Threaded Adapter (5/8 - 18 F. X 1/2 - 20 M.)
	8007	2	Male/Female Threaded Adapter (5/8 - 18 F. X 1/2 - 13 M.)
	8010	2	Male/Female Threaded Adapter (5/8 - 18 F. X 5/8 - 11 M.)
	8013	2	Male/Female Threaded Adapter (5/8 - 18 F. X 3/4 - 16 M.)
	8015	2	Male/Female Threaded Adapter (5/8 - 18 F. X 3/4 - 10 M.)
	8019	2	Male/Female Threaded Adapter (5/8 - 18 F. X 1" - 14 M.)
8	927	1	Push-puller (10 ton with 6-3/4 legs)
9	1122	1	Bearing Pulling Attachment
10	8035	1	Female Threaded Adapter (1/2 - 20 X 5/8 - 18)
	8037	1	Female Threaded Adapter (5/8 - 18 X 5/8 - 18)
	8038	1	Female Threaded Adapter (5/8 - 18 X 3/4 - 16)
	8039	1	Female Threaded Adapter (5/8 - 18 X 7/8 - 14)
	8040	1	Female Threaded Adapter (5/8 - 18 X 1" - 14)
11	1123	1	Bearing Pulling Attachment

PARTS INCLUDED BUT NOT SHOWN

8050	1	Shaft Protector (1-1/2 O.D.)
8051	1	Shaft Protector (1-1/4 O.D.)
8052	1	Shaft Protector (1" O.D.)
8053	1	Shaft Protector (3/4 O.D.)
8057	1	Step Plate Adapter (1" O.D. X 3/4 I.D.)
8058	1	Step Plate Adapter (1-1/8 O.D. X 7/8 I.D.)
8059	1	Step Plate Adapter (1-1/4 O.D. X 1" I.D.)
8060	1	Step Plate Adapter (1-3/8 O.D. X 1-1/8 I.D.)
8061	1	Step Plate Adapter (1-5/8 O.D. X 1-1/4 I.D.)
8062	1	Step Plate Adapter (1-3/4 O.D. X 1-3/8 I.D.)

