

**10 TON MANUAL PULLER SETS**

To Parts List

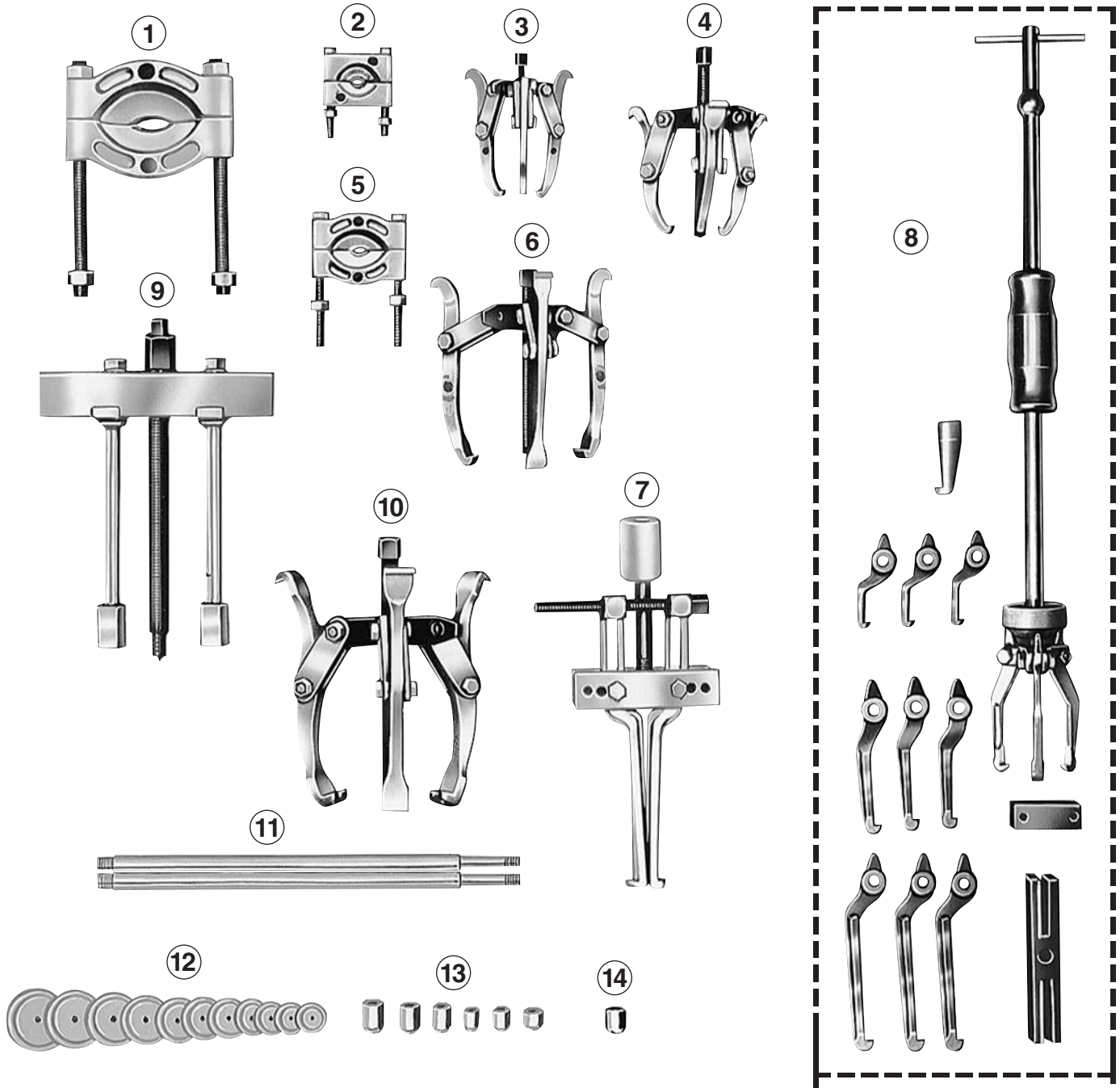

# Parts List, Form No. 101758, Back sheet 1 of 1

---

Item No.	Part No.	No. Req'd	Description
1	1123	1	Bearing Pulling Attachment
2	1121	1	Bearing Pulling Attachment
3	1023	1	Combination Puller (2 ton; 2/3 jaw)
4	1026	1	Combination Puller (5 ton; 2/3 jaw)
5	1122	1	Bearing Pulling Attachment
6	1027	1	Combination Puller (5 ton; 2/3 jaw)
7	1151	1	Bearing Cup Pulling Attachment
8	1178	1	Slide Hammer Set
9	927	1	Push-puller (10 ton with 6-3/4" legs)
10	1037	1	Combination Puller (7 ton; 2/3 jaw)
11	1101	1 pr.	Puller Legs (15 3/4)
12	8075	11 pcs.	Step Plate Adapter Set
13	8044	6 pcs.	Female Threaded Adapter Set
14	8035	1	Female Threaded Adapter (1/2 - 20 X 5/8 - 18)

