

## 17 1/2 TON HYDRAULIC PULLER SET

To Parts List

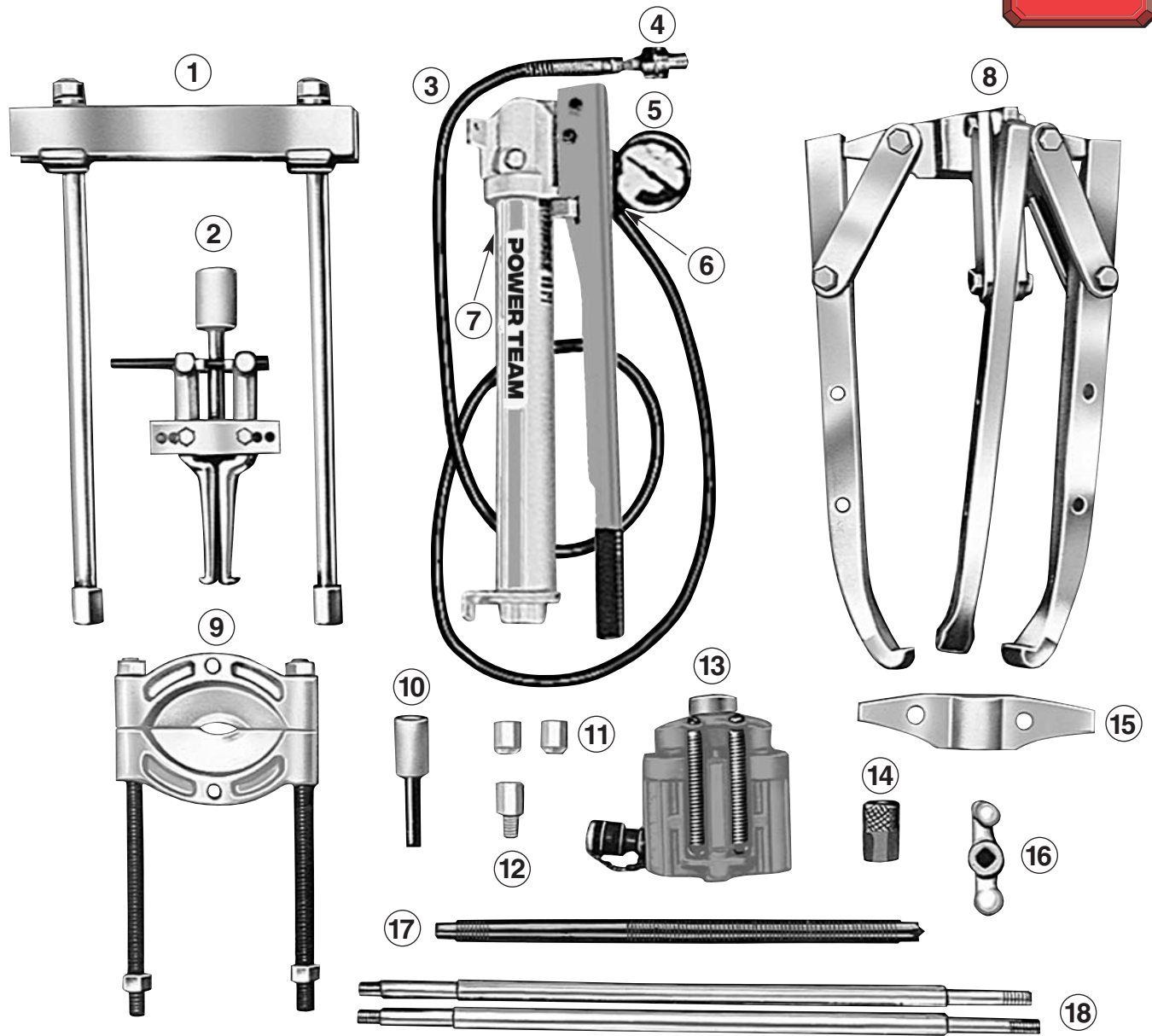

# Parts List, Form No. 101763, Back sheet 1 of 1

---

Item No.	Part No.	No. Req'd	Description
1	1062	1	Push-puller With 16 1/2" Legs (17 1/2 ton)
2	1154	1	Bearing Cup Pulling Attachment
3	9767	1	Hydraulic Hose - 6'
4	9798	1	Hose Half Coupler
5	9059	1	Pressure Gauge
6	9670	1	Tee Adapter
7	P55	1	Hand Pump Assembly (Single-Stage)
8	1066	1	Puller (17 1/2 ton; 3 jaw)
9	1130	1	Bearing Pulling Attachment
10	201454	1	Pushing Adapter
11	8038	2	Female Threaded Adapter (5/8 - 18 F. X 3/4 - 16 F.)
12	8020	1	Male/Female Threaded Adapter (1" - 8 F. X 5/8 - 18 M.)
13	RT172	1	Twin Cylinder With Threaded Insert (17 1/2 ton)
14	28228	1	Pushing Adapter
15	41224	1	2-Jaw Head (For 1066)
16	24814	1	Speed Crank
17	32118	1	Cylinder Adjusting Screw
18	1105	1 pr.	Puller Legs (22 1/2")

