

**MODEL B**  
**DOUBLE-ACTING**  
**HYDRAULIC CYLINDER**  
Max. Capacity: 500 Tons at 10,000 PSI

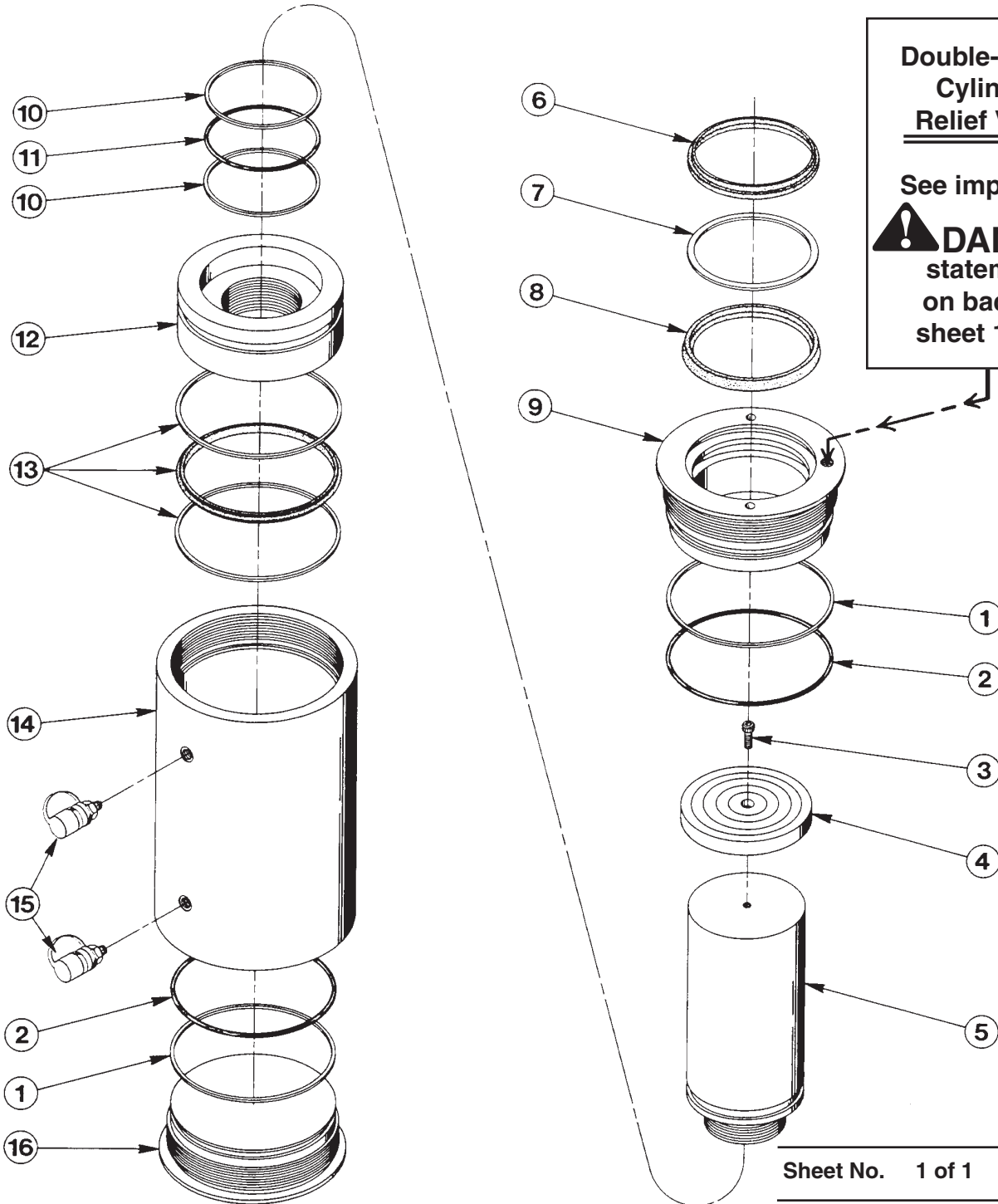

**Double-acting  
Cylinder  
Relief Valve**

See important  
**! DANGER**  
statement  
on back of  
sheet 1 of 1



**DANGER:** To help avoid possible serious personal injury or death,

- In the event that the cylinder retract port is ever restricted or plugged, a double-acting cylinder relief valve will help prevent excessive pressure from building in the cylinder. **DO NOT** attempt to adjust or service this relief valve! If oil leakage is detected from this relief valve, discontinue use of the cylinder immediately and contact **Power Team Technical Services**. Only Power Team Authorized Hydraulic Service Centers should service this relief valve.

| Item No. | Part No.  | No. Req'd | Description                               |
|----------|-----------|-----------|---|
| 1        | *212708   | 2         | Backup Washer (11" X 10-1/2 X .095)       |
| 2        | *212711   | 2         | O-ring (11-1/4 X 10-3/4 X 1/4, special)   |
| 3        | 252356    | 1         | Cap Screw (3/8-16 UNC X 5-1/2" Lg.)       |
| 4        | 58898     | 1         | Serrated Insert                           |
| †5       | 58899-" " | 1         | Piston Rod                                |
| 6        | *212715   | 1         | Rod Wiper                                 |
| 7        | *212714   | 1         | Backup Washer (9" X 8" X .496)            |
| 8        | *212713   | 1         | U-cup                                     |
| 9        | 61437     | 1         | Piston Retainer (Torque to 1000 ft. lbs.) |
| 10       | *212709   | 2         | Backup Washer (8" X 7-1/2 X .095)         |
| 11       | *212712   | 1         | O-ring (8" X 7-1/2 X 1/4)                 |
| 12       | 52734     | 1         | Piston Head                               |
| 13       | *212710   | 1         | T-Seal & Backup Rings                     |
| †14      | 65453-" " | 1         | Cylinder Body                             |
| 15       | 9796      | 2         | Ram Half Coupler w/Dust Cap               |
| 16       | 65450     | 1         | Retainer Nut (Torque to 650 ft. lbs.)     |

**PARTS INCLUDED BUT NOT SHOWN**

- 37782 1 Warning Decal
- 351405 1 Trade Name Decal
- 52725 1 Handle Assembly
- 420900 1 Spacer (For stroke lengths from 32" thru 48")



Part numbers marked with an (\*) asterisk are contained in Repair Kit No. 300468.

† To order the correct piston rod and cylinder body for your specific model, list the stroke length as a suffix to the item part number.  
 For example: 58899-6 = 6" stroke  
 58899-10 = 10" stroke  
 OR  
 65453-10 = 10" stroke  
 65453-13 = 13" stroke

Refer to any operating instructions included with this product for detailed information about operation, testing, disassembly, reassembly, and preventive maintenance.

Items found in this parts list have been carefully tested and selected. **Therefore: Use only genuine Power Team replacement parts!**

Additional questions can be directed to our Technical Services Department.

Note: Shaded areas reflect last revision(s) made to this form.