

**4-WAY, SOLENOID CONTROLLED, PILOT OPERATED, OPEN CENTER
 DIRECTIONAL VALVE**

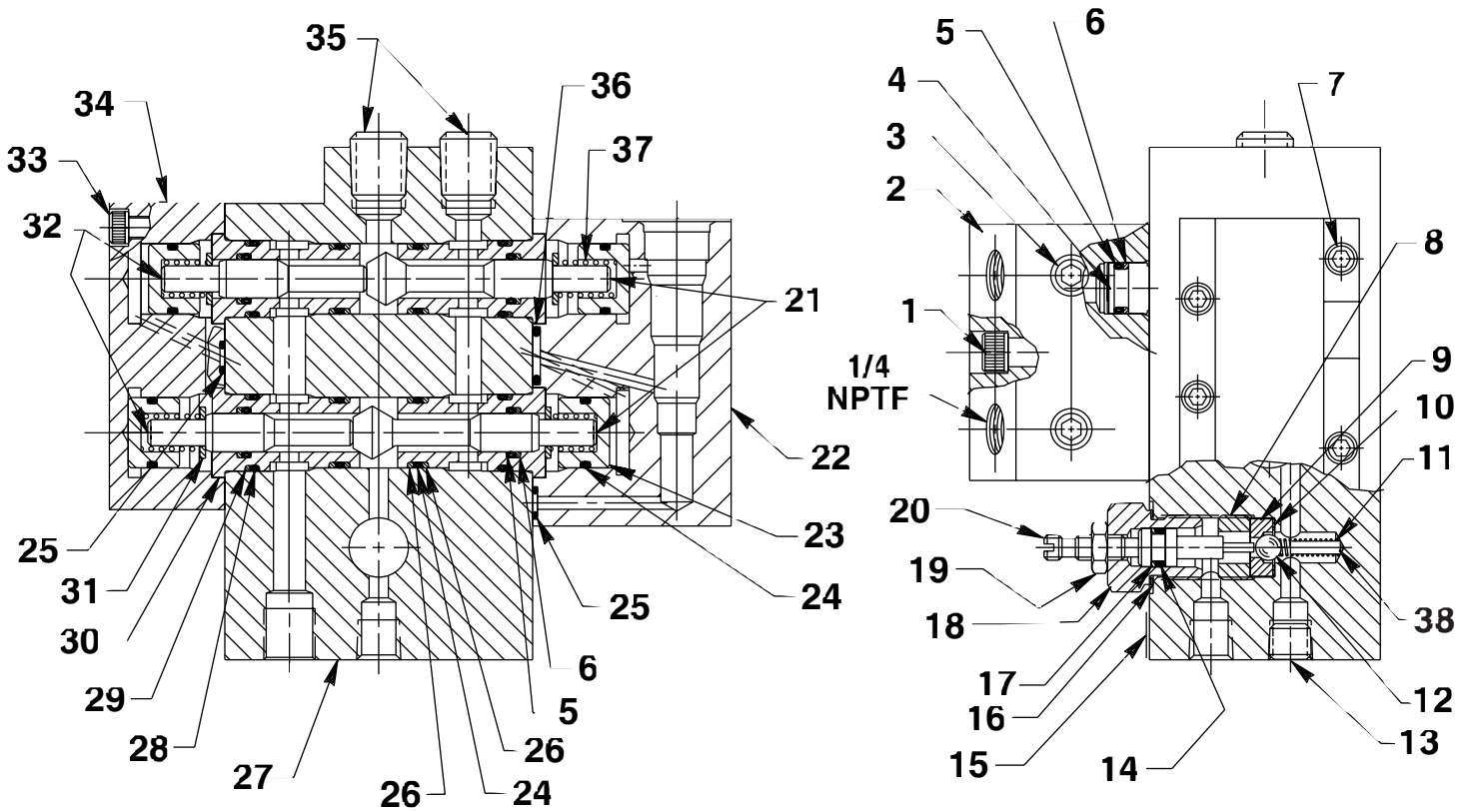

Parts List, Form No. 107427, Back sheet 1 of 1

Item No.	Part No.	No. Req'd	Description
1	10854	2	Cap Screw (1/4-20UNC X 1-3/4 Lg.; Torque to 150/180 in. lbs.)
2	421856	1	Manifold
3	10427	2	Pressure Plug (1/8 NPTF)
4	21094	2	Bushing
5	*10268	8	O-ring (1/2 X 3/8 X 1/16)
6	*11863	8	Backup Washer (1/2 X 3/8 X 1/16)
7	14426	4	Cap Screw (#10-24 UNC X 1" Lg.; Torque to 50/70 in. lbs.)
8	212735	1	Hollow Lock Screw (5/8-18 UNF x 5/16 Lg.; Torque to 180/200 in. lbs.)
9	351200	1	Replaceable Seat
10	12042	1	Copper Washer (9/16 X 3/8 X 1/32)
11	10361	1	Compression Spring (1/4 O.D. X 1" Lg.)
12	10375	1	Steel Ball (1/4 Dia.)
13	251279	1	Plug (1/8 PTF)
14	10266	1	O-ring (3/8 X 1/4 X 1/16)
15	252164	1	Decal
16	252099	1	Copper Washer
17	12184	1	Backup Washer (3/8 X 1/4 X .048)
18	252053	1	Valve Cap (Torque to 150/180 in. lbs.)
19	10383	1	Hex Jam Nut (1/4-20 UNC)
20	351257	1	Bushing
21	*200542	2	Poppet
22	64648	1	Right End Cap
23	22070	4	Piston
24	*11284	8	O-ring (11/16 X 9/16 X 1/16)
25	*10265	6	O-ring (5/16 X 3/16 X 1/16)
26	*12391	8	Backup Washer (11/16 X 9/16 X .048)
27	65095	1	Valve Body
28	*10302	4	O-ring (3/4 X 5/8 X 1/16)
29	*12392	4	Backup Washer (3/4 X 5/8 X 1/16)
30	*22068	4	Bushing
31	209541	4	Washer
32	200541	2	Poppet Half
33	11151	4	Cap Screw (10-24 UNC X 1-1/4 Lg.; Torque to 50/70 in. lbs.)
34	420902	1	Left End Cap
35	10479	2	Pipe Plug (1/4 NPTF)
36	*10269	1	O-ring (9/16 X 3/8 X 3/32)
37	10362	4	Compression Spring (3/8 O.D. X 3/4 Lg.)
38	12955	1	Dowel Pin (.19 x .50)

Part numbers marked with an asterisk (*) are contained in Repair Kit No. 351005-KIT.